

**ELECTRICAL CAR CHARGING**

Ducting to be laid to all car parking spaces in this development to enable, if required, the establishment of private EV charging points for each unit and a number of EV charging points for general public use.

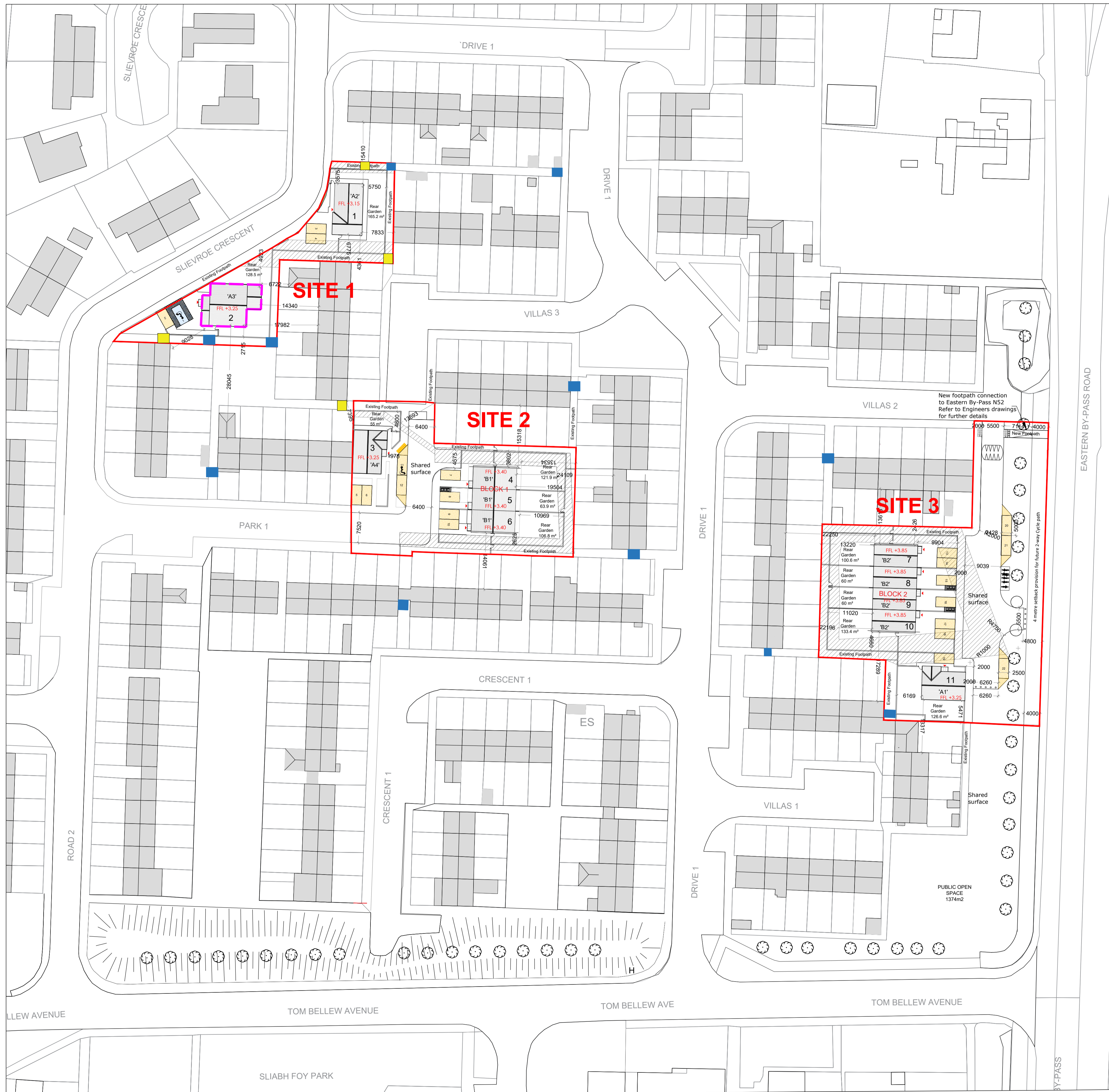
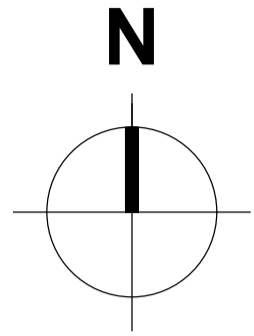

**Site Area**

Area of Site 1:	0.1074 Ha (1074m <sup>2</sup> )
Area of Site 2:	0.1747 Ha (1747m <sup>2</sup> )
Area of Site 3:	0.2962 Ha (2962m <sup>2</sup> )
<b>Total Area of Sites:</b>	<b>0.5783 Ha (5783m<sup>2</sup>)</b>

**Public Open space**

Public Open space:	0.1373 Ha (1373m <sup>2</sup> )
Percentage of Open space to Area of the Site:	23.7%

**Legend**

- Site Outlined in Red
- 1/ 11no. Overall number of houses
- + FFL +16.90 Proposed finished Floor Level
- Dwelling Principal Entrance
- Bin Enclosure
- House highlighted as OT Special Need Units
- Disable Parking Space
- Parking Space
- Existing Tree to be retained
- Irish Water 'No Build Zones'
- Existing LCC Pedestrian Gate
- Proposed LCC Pedestrian Gate
- Existing Pedestrian Gate
- Proposed Louth CC Pedestrian Gate

**Area**

Area of Site:	0.5783 Ha
Public Open Space Provided:	1373m <sup>2</sup>
Car Parking Spaces:	22 spaces
Disable Car Parking Spaces:	2 spaces
BICYCLE STANDS	12 spaces

**Schedule of Accommodation**

Residential Units:	
House Type A1: 2 Bed, 3 person Single-storey dwelling	- 1 No.
House Type A2: 2 Bed, 4 person Single-storey dwelling	- 1 No.
House Type A3: 3 Bed, 5 person Single-storey dwelling with OT Report	- 1 No.
House Type A4: 2 Bed, 3 person Single-storey dwelling	- 1 No.
House Type B1: 3 Bed, 5 person Two-storey dwelling	- 3 No.
House Type B2: 3 Bed, 5 person Two-storey dwelling	- 4 No.
<b>TOTAL - 11 Units shown</b>	

Rev.	By	Date	Description
A	AS	08/11/2021	PART 8 ISSUE



Mill House, Mill Street, Dundalk, Co. Louth info@vandijkarchitects.com  
 +353 (0) 42 935 4466 www.vandijkarchitects.com

<b>SITE LAYOUT PLAN PART 8 ISSUE</b>			
Scale:	1: 500	Drawing Number:	2018-PA-003
Author:	A	Client:	LOUTH CO. CO.
Designer:	SG	Drawing by:	AH
		Date:	08/11/2021

All works to be carried out using proper materials which are fit for the use they are intended and for the condition in which they are to be used. All materials used in connection with the works to comply with the construction products regulation (eu) no. 305/2011 and the harmonised technical specifications/standards that fall within the remit of the pr no. 305/2011.  
 Figured dimensions must be used in preference to scaled dimensions. Any dimensional discrepancies must be reported to the Architect immediately. This drawing remains the copyright of van Dijk Architects. It must not be used for any purpose building or otherwise without the express permission of this practice. Do not copy or redistribute these drawings or any additional information without the expressed approval of van Dijk Architects.